

i.tech STONE-HOLD

Cement for Stone Work

PRODUCT DESCRIPTION:

i.tech STONE-HOLD cement, when used in the recommended formulations, is an excellent choice for today's stone construction applications. It provides optimal bond strength while maintaining excellent workability. This proprietary formulation also improves resistance to cracking during freeze/thaw cycles.

BENEFITS:

- Excellent durability.
- Superior strength and adhesion.
- Consistent workability.
- Compatible with natural and manufactured stone for exterior or interior applications.

APPLICATIONS:

i.tech STONE-HOLD cement is specially formulated for mortar and grouting with natural and manufactured stone.

AVAILABILITY & PRICING:

Contact your Essroc Sales Representative for availability and pricing in your area.

TYPES AND USES:

Based on application experience, for every 100 square feet of stone surface, you will need an estimated three bags of i.tech STONE-HOLD cement. Using the following recommended formulations will reduce shrinkage cracks, and improve overall performance.

Mortar for Wall and Stone Surface	
	Parts by Volume
	i.tech STONE-HOLD 1 Part
	Masonry Sand 2¼ Parts

Grout Proportions for Stone Work	
	Parts by Volume
	i.tech STONE-HOLD or i.design flamingo-BRIXMENT 1 Part
	Masonry Sand 3 Parts



PACKAGING:

i.tech STONE-HOLD is packaged in 75 lbs. (34 kg) multi-walled bags. Packages should be kept free from moisture.

APPLICABLE STANDARDS:

i.tech STONE-HOLD conforms to the requirements of ASTM C 1329, Standard Specification for Mortar Cement and ASTM C 91, Standard Specification for Masonry Cement. i.tech STONE-HOLD cement for stone work should be used in accordance with local building codes. Consult all instructions and requirements provided by the stone manufacturer prior to installation.

MIXING:

Assure that the mixing equipment is clean and in good working order. Provide a one cubic foot box or other suitable container for volumetric measuring of aggregate. Aggregate shall conform to the requirements of ASTM C 144. Water shall be potable. i.tech STONE-HOLD should be mixed with 2 ¼ to 3 cubic feet of sand according to Table 1 Proportion Specification of ASTM C 270. Start the mixer, place ¾ of the required amount of water, ½ the required amount of sand and all the i.tech STONE-HOLD into the mixer. Mix briefly. Add the remaining sand and water to the mixer and mix for a minimum of 3 and a maximum of 5 minutes after the last mix water has been added. This assures homogeneity and workability of the mortar. Although minor retempering is allowed, mortar should be used or discarded after 90 minutes.

STONE INSTALLATION:

IMPORTANT: First consult the stone manufacturer's instructions.

Properly prepare surfaces. Apply ½ inch of mortar over concrete masonry unit (CMU) wall, sheathing or rigid insulation (see diagram right). Apply ¾ inch of mortar to the back of each stone unit. Cover back completely. Press coated unit firmly on wall. Some mortar should be squeezed out around the stones' edges. Ensure complete coverage between vertical surface and back surface of the stone.

FINISHING JOINTS:

Use a grout bag to fill in joints. Avoid smearing on stone. Accidental smears should be removed only when dry. Use a dry brush. Finish joints when surface is 'thumb-print' hard with a metal or brush tool.

PRECAUTIONS:

Minimize direct contact with wet cement. Exposure of sufficient duration to wet portland cement can cause serious, potentially irreversible tissue (skin or eye) destruction in the form of chemical (caustic) burns. Consult the relevant MSDS before working with i.tech STONE-HOLD.

WARRANTY:

Essroc warrants that its products are free from manufacturing defects and conform to applicable ASTM standards. Essroc makes no warranty or guarantee, express or implied, including warranties of fitness for a particular purpose or merchantability, respecting its products. User assumes all risks and liability in connection with the suitability of the products for the intended use.

FOR MORE INFORMATION:

For more information on Essroc's products call 800-4-ESSROC or visit us online at www.essroc.com.

Essroc Italcementi Group

3251 Bath Pike

Nazareth, PA 18064

800-4-ESSROC

www.essroc.com

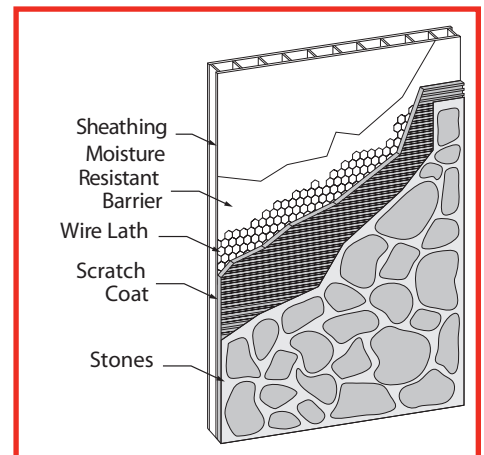

July 2013